

# Hoopla Digital Account Set-up Instructions: Computers

1. Go to Hoopla Digital's website at [www.hoopladigital.com](http://www.hoopladigital.com)
2. To begin set-up, click on 'GET STARTED TODAY'

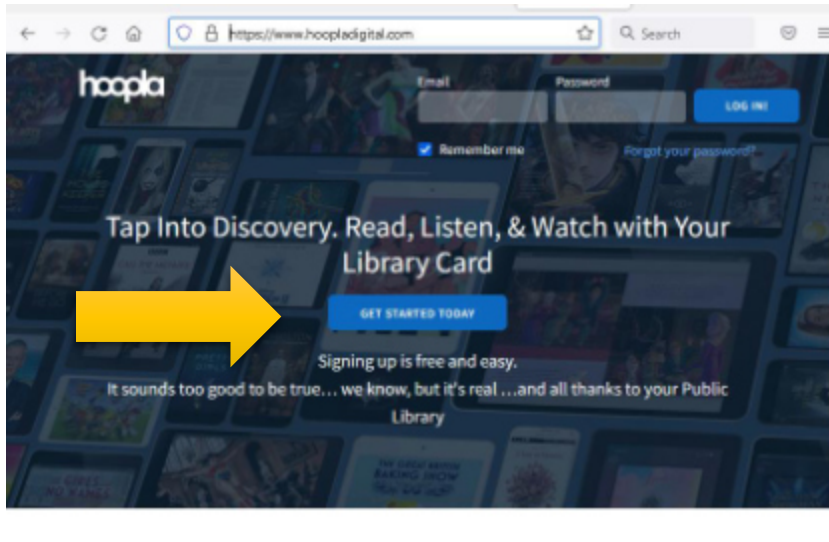

3. A pop-up window will appear. Enter requested information, then press 'Agree'

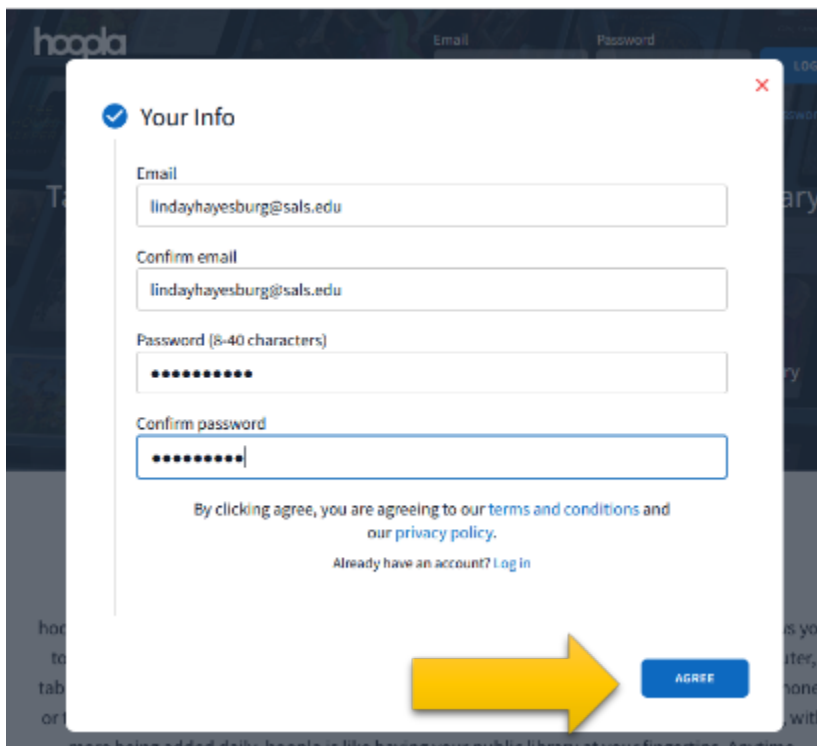

4. Select your library: Town of Chester Public Library. Then press 'Next'.

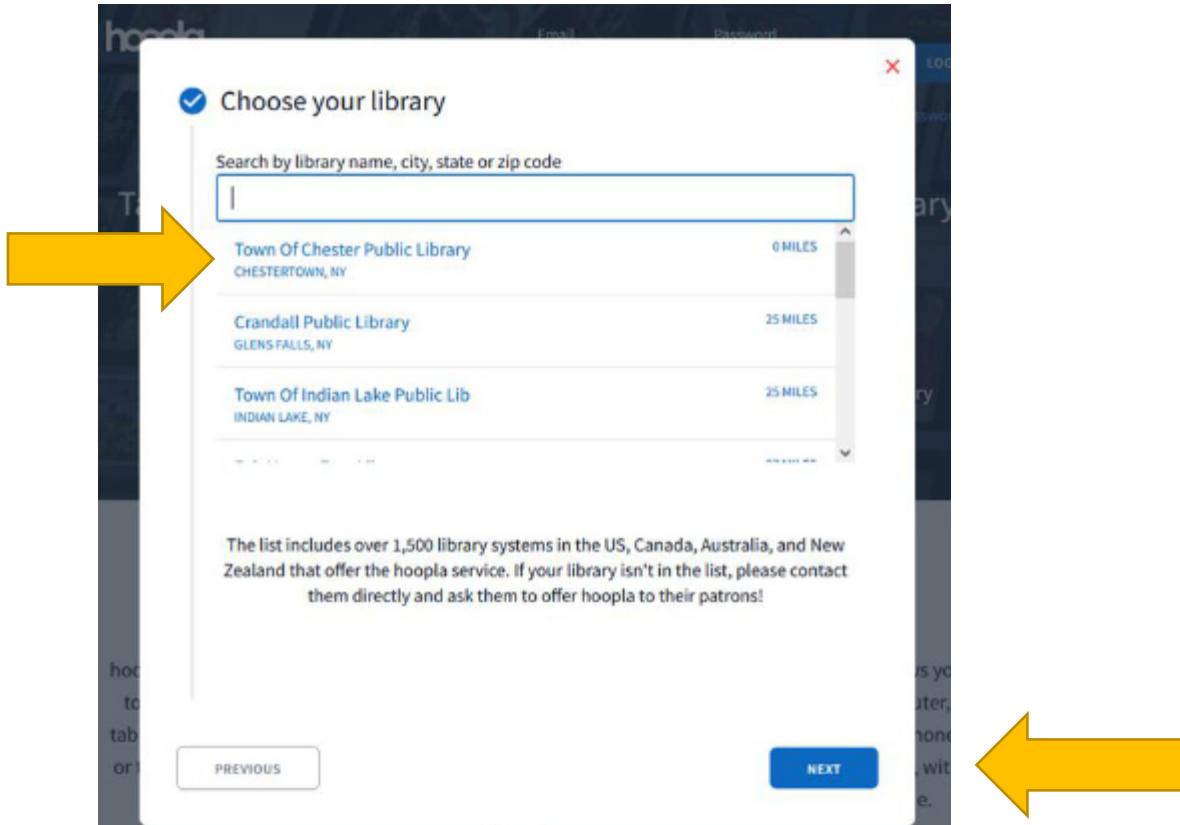

5. A new pop-up window will appear requesting your library card number. (Your library card number is located on the back of your card below the barcode.) Enter your library card number then click on 'SIGN ME UP'.

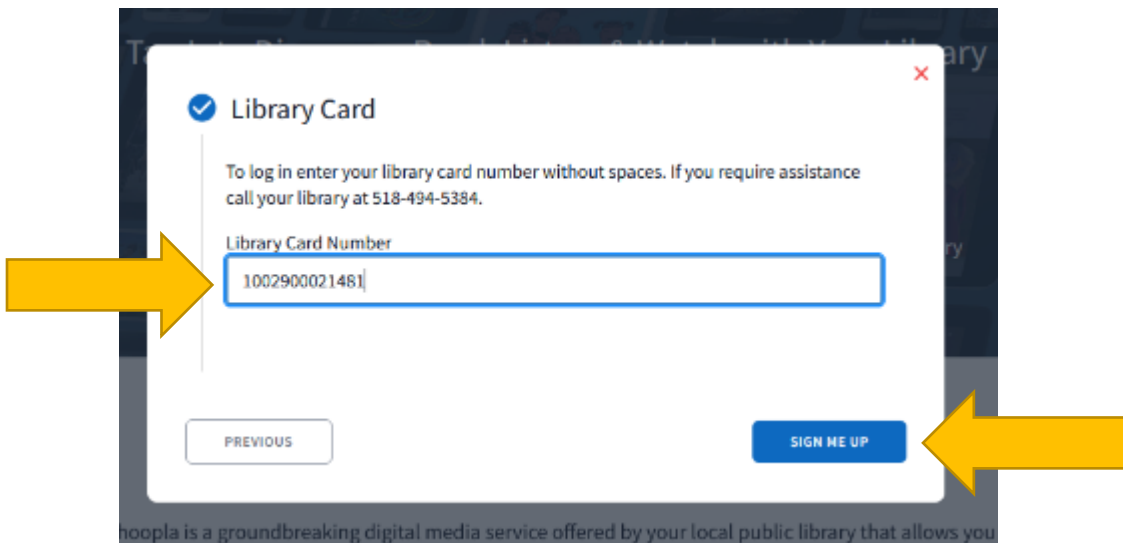

6. Your set-up is now complete. A new pop-up window will appear. Click on 'DONE' to enter the Hoopla Digital website.

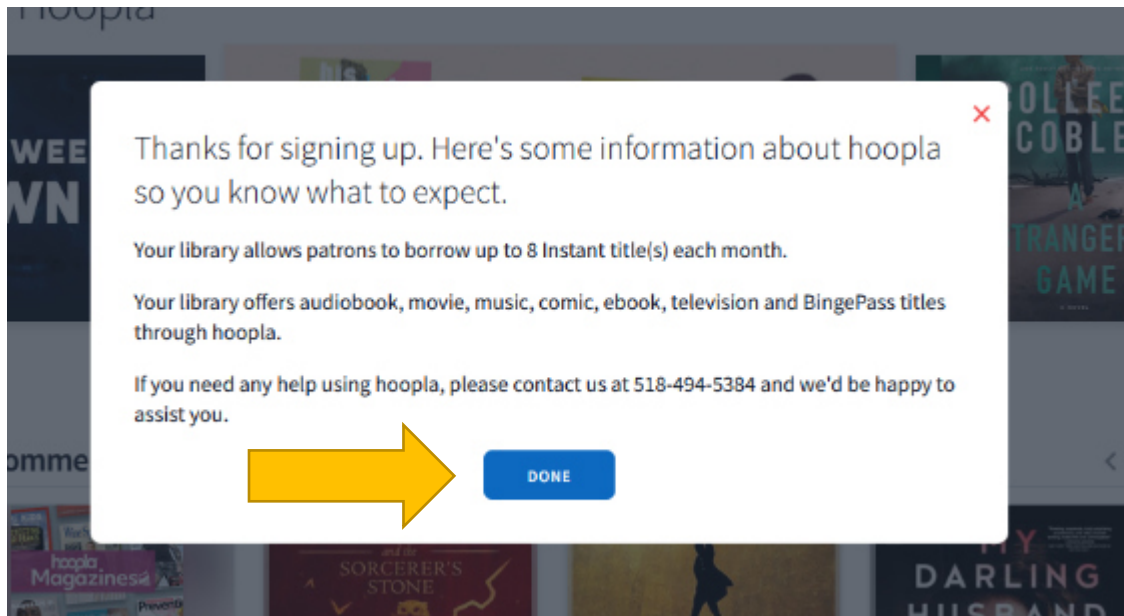

**Welcome to Hoopla Digital!**